

Quick Start Guide

Smart Wi-Fi Light Switch, Dimmer, Two-Gang

©2023 TP-Link 7106510734 REV3.2.0

*Images may differ from your actual product.

- 1 **Turn off** the circuit breaker for all switches in the wallbox. Check whether your power is off by turning your switches on and off a few times. Make sure your old switches are turned off before continuing wiring.

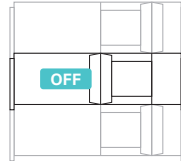

CAUTION !



1. Risk of Electric Shock - The product should be installed by a qualified electrician.
2. High Voltage - Disconnect power supply at the circuit breaker before servicing.
3. Use copper conductors only

- 2 Remove the old wallplate. Use a voltage detector to test terminals and other metal parts to confirm that all power is off.

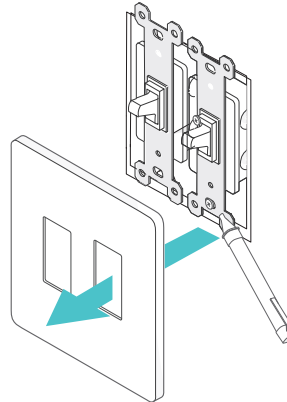

- 3 Unscrew one of the two old switches and pull it out. Use a voltage detector to test all wires connected to the old switch and in the wallbox to confirm that all power is off for the wallbox.

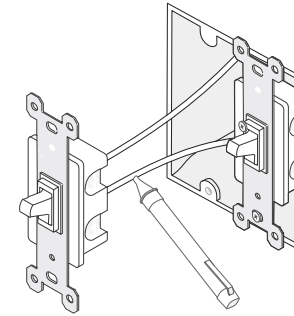

- 4 Take a picture of the wires. Label the **Ground** and **Neutral** wires of the pulled out switch.

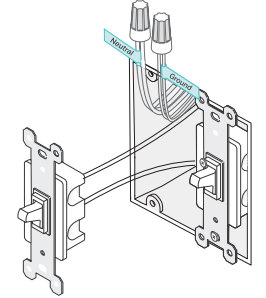

- **Neutral:** Usually a bundle of white wires not connected to the old switch. They may be folded up in the very back of your wallbox. If the old switch is smart, then the neutral wire may be connected to the switch.
 - **Ground:** Usually a green or bare copper wire.
 - **Line:** Usually black, coming from the circuit breaker.
 - **Load:** Usually black. One end is connected to the light.
- If you are unsure, consult a qualified electrician.

- 5 Disconnect all wires from the pulled-out switch and identify the **Line** and **Load** wires.

- 1) **Turn on** the circuit breaker. Use a voltage detector to identify the energized wire (**Line wire**). The non-energized wire is the **Load** wire.

⚠ Take care to avoid electric shocks.

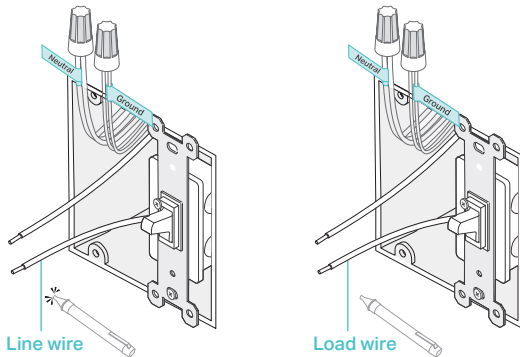

- 2) **Turn off** the circuit breaker. Label the **Line** and **Load** wires.

- 6 Connect the wires to one of your smart switches as shown below. Check that all of the wires are correct. Then follow the same steps to replace the other old switch with your smart switch.

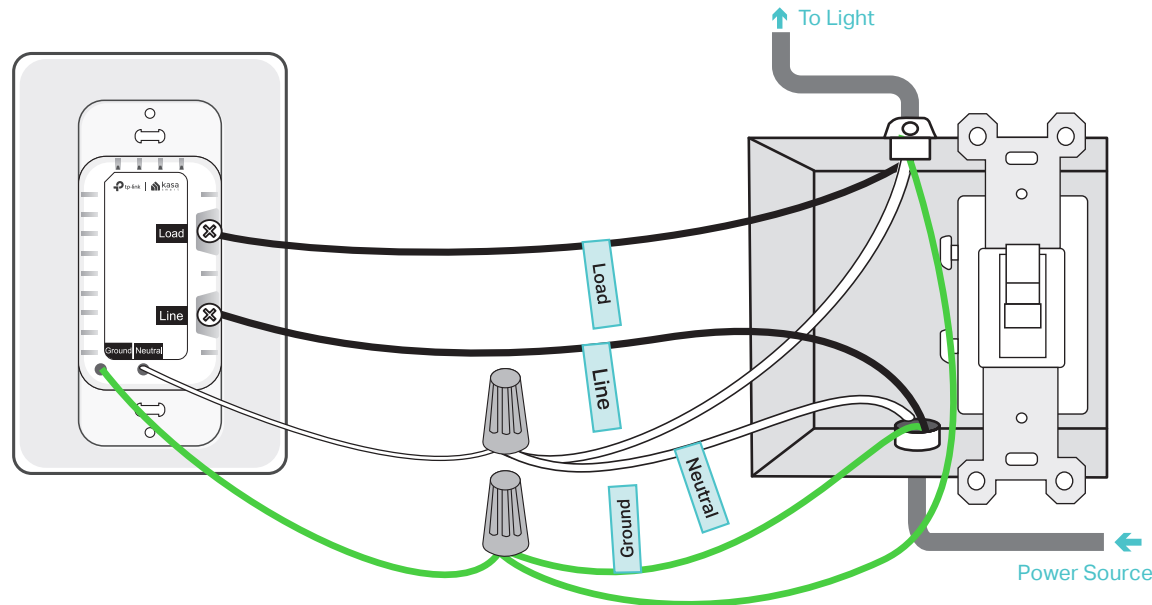

- 7 Screw the switches to the mounting holes without fully tightening them. You may need to fine tune the positions of the two switches later to fit properly into the wallplate.

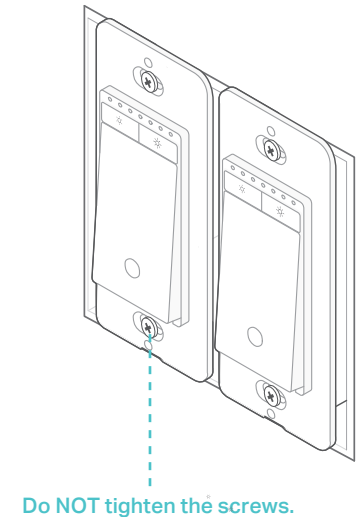
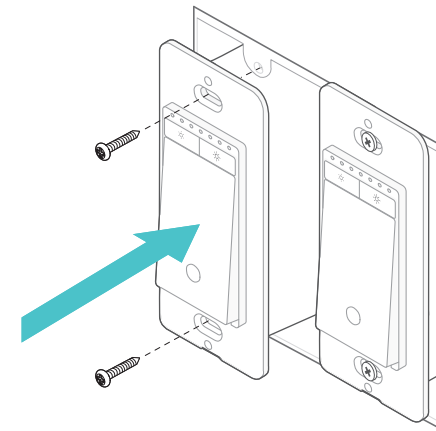

Do NOT tighten the screws.

8 Use the provided mounting template to help line up the two switches with the mounting holes. Then tighten the screws. Set the mounting template aside and attach the wallplate.

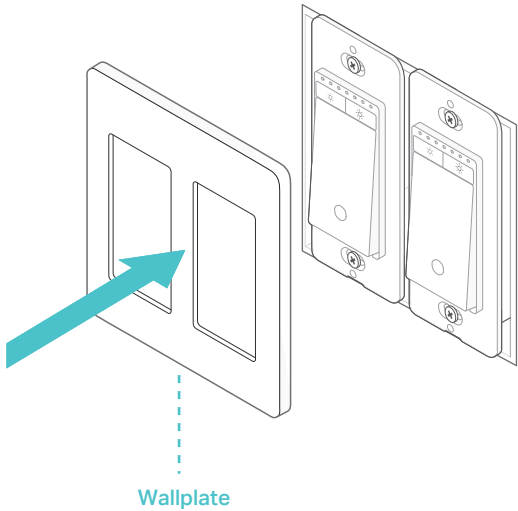
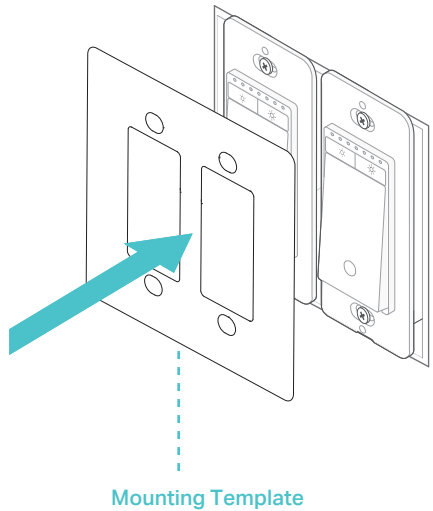

9 Turn on the circuit breaker and turn on the lights to check your work.

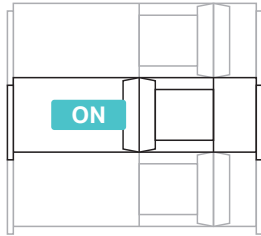

Appearance

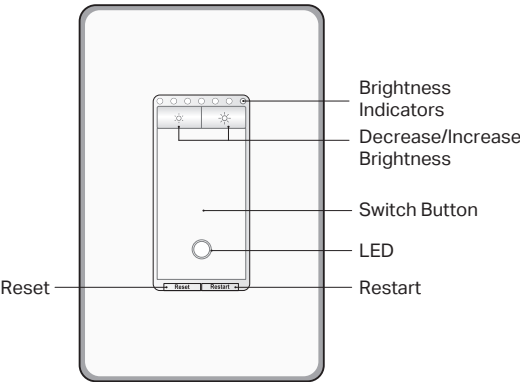

Button Explanations

	Decrease or increase the brightness.
Reset	Press and hold for about 5s until the LED blinks amber and green to reset Wi-Fi while keeping other settings. Press and hold for about 10s until the LED blinks amber to restore factory default settings.
Restart	Press to restart your dimmer switch.

LED Status

Solid amber	Starting up.
Blinking amber & green	Ready for setup; Resetting Wi-Fi.
Blinking green	Connecting to Wi-Fi.
Solid green for 30s	Connected to Wi-Fi.
Solid red	Disconnected from Wi-Fi.
Blinking amber	Device resetting.
White	Light fixture is off.

Specifications

Rating: 120V~ 60Hz
Max Load (Each Gang): 300W Incandescent/Halogen, 150W LED
Dimming Type*: Leading Edge Dimming / TRIAC Phase Cut
In-Wall depth: 1.35in (34.2 mm)
Operation temperature: 0~40°C
*We recommend contacting your bulb's customer support to verify its compatible dimming options.

Method of mounting included: Independently mounted (Vertically position only);
Operating control, Type 1.Y action
Pollution Degree 2, Rated Impulse Voltage 2500 V
Software Class A, Environmental - IP20 (NEMA 1)

CAUTION

High Voltage-Disconnect power supply at the circuit breaker before servicing

MISE EN GARDE

Haute tension : débranchez l'alimentation électrique au niveau du disjoncteur avant l'utiliser

Set Up Your Switch

DOWNLOAD APP

Get the **Kasa Smart** app from the App Store or Google Play.



ADD TO KASA

- Set up the first dimmer switch:
Tap the ⊕ button in the app and select **Smart Switches > Smart Dimmer (Wi-Fi)**. Then follow the app instructions to complete setup.
- Set up the second dimmer switch following the same steps.

THIRD-PARTY SERVICES

Kasa works with Alexa, Google Assistant, and other third-party services to control your switch by voice. Go to **Me > Third-Party Services** in the Kasa Smart app to integrate the third-party services.

For step-by-step setup instructions, please visit:

- Google Home Assistant:
<https://www.tp-link.com/support/faq/1534/>
- Amazon Alexa:
<https://www.tp-link.com/support/faq/944/>



Need some help?
Visit <https://www.tp-link.com/support> for technical support, user guides, FAQs, warranty & more